

### RECOMMENDED INSTALLATION OF THE SENNINGER®

# i-Wob®2 Part-Circle

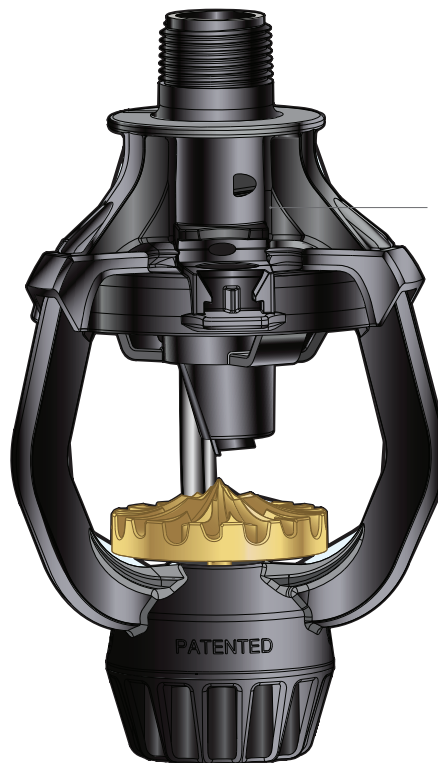

#### I-WOB2 PART-CIRCLE

(Mustard deflector)

Part Number -  
**IWOB200B3PCUP3**  
(excluding nozzle)

Part Number -  
**IWOB2xxxB3PCUP3**  
(including nozzle -  
add the nozzle number  
to replace xxx for the  
complete part number)



#### UP3® NOZZLES

Part Numbers -  
**UP3NZ07 - UP3NZ26**  
#07 - #26

#### NOZZLE REMOVAL



#### NOZZLE INSTALLATION



#### NOZZLE VISIBILITY

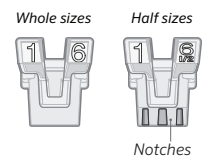

Installation Specifications

I-WOB®2 PART-CIRCLE SYSTEM ASSEMBLY

- Always mount the i-Wob2 Part-Circle on the outlet end of any semi-rigid, rigid drop, or boom.
- Always mount the i-Wob2 Part-Circle so that the inserted operating UP3® nozzle ears face the opposite direction of the distribution pattern.



- Mount the i-Wob2 Part-Circle no less than 3 ft (0.91 m) above the ground.
- Pressure regulators can be installed at the top of the drop or near the applicator. Follow your customized printout for proper pressure regulator placement)

I-WOB2 PART-CIRCLE DESIGN CRITERIA	Part-Circle 16-Groove - Mustard Medium Droplet
Nozzle Sizes	
Minimum	#7 7/64" 2.78 mm
Maximum *	#26 13/32" 0.32 mm
Flows	
At 10 - 15 psi At 0.69 - 1.03 bar	1.09 - 18.35 gpm 248 - 4168 L/hr
Radii	
At 3 ft height At 0.91 m height	16 - 19 ft 4.9 - 5.8 m
At 6 ft height At 1.83 m height	20 - 24 ft 6.1 - 7.3 m
At 9 ft height At 2.74 m height	22 - 26 ft 6.7 - 7.9 m
Pressure at the Nozzle	
Minimum	10 psi 0.69 bar
Maximum	15 psi 1.03 bar

\* It is recommended that larger nozzle sizes be used only on soils that can handle higher application rates.

