

AGRICULTURAL IRRIGATION | A Hunter Industries Company
LOW PRESSURE - HIGH PERFORMANCE™



- 01 Convenient:** Visible bright yellow riser stem and cap confirm system operation
- 02 Reliable:** Stem pops up when pressure exceeds the threshold, indicating low pressures if not raised.
- 03 Flexible:** Connects via side inlet port for easy installation

VISUAL PRESSURE INDICATOR (VPI)

Visual Assurance for Your Peace of Mind.

The VPI is a visual device that provides an easy way to confirm system operation and adequate pressure. Its simple design and easy installation make it a handy choice for many farmers. When the system runs and the pressure is above 15 psi (1.03 bar), the bright yellow indicator stem extends to 12 inches (30.5 cm) in height, offering a clear signal. When the pressure drops below 10 psi (0.69 bar), the VPI retracts out of sight.



VISUAL PRESSURE INDICATOR (VPI)

INSTALLATION

1. Install one 3/4" x 1/2" NPT nipple (FTN 32BR) into the side inlet of the body and tighten.
2. Install the 3/4" x 3/4" NPT coupling (CPL33) onto the fitting previously installed and tighten by hand.
3. Install one 3/4" x 1/2" NPT nipple (FTN 32BR) into the bottom inlet of the body and tighten.
4. Install the drain (MAXSAFB15PSL) onto the other end of the adapter and tighten.
5. Using a 3/4" NPT tee (not included), connect the VPI to any span outlet you choose near the end of the machine. Use a 3/4" NPT nipple (not included) long enough to provide clearance for the VPI based on pipe diameter.

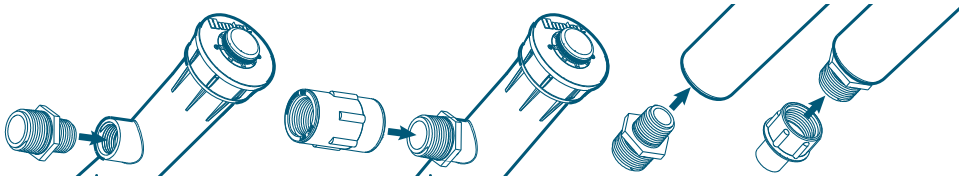

While not mandatory, Teflon tape can be used on the fittings during assembly for added security. Avoid using pipe dope.



Shown above: Components per box.

SPECIFICATIONS

- Operating pressure: up to 100 psi (6.89 bar)
- Indication of system operation: above 15 psi (1.03 bar)
- Warranty period: 1 year
- Retracted height: 16-1/8" (41 cm)
- Pop-up additional height: 12" (30.5 cm)
- Exposed diameter: 2-1/4" (5.7 cm)
- Inlet size: 1/2" NPT (1.3 cm)

FREQUENTLY ASKED QUESTIONS

Q: At what pressure does the VPI indicator begin to extend?

A: At 12 psi (0.83 bar), the indicator begins to extend, and water will be expelled from the drain.

Q: At what pressure is the VPI indicator fully extended?

A: At 15 psi (1.03 bar), the indicator will be fully extended. The drain will seal, and water will no longer be expelled.

Q: At what pressure is the VPI indicator fully retracted?

A: When the pressure drops to 10 psi (0.69 bar), the indicator begins to retract slowly. The drain opens, and water is expelled. When the pressure reaches 7 to 8 psi (0.50 to 0.55 bar), the indicator retracts fully.

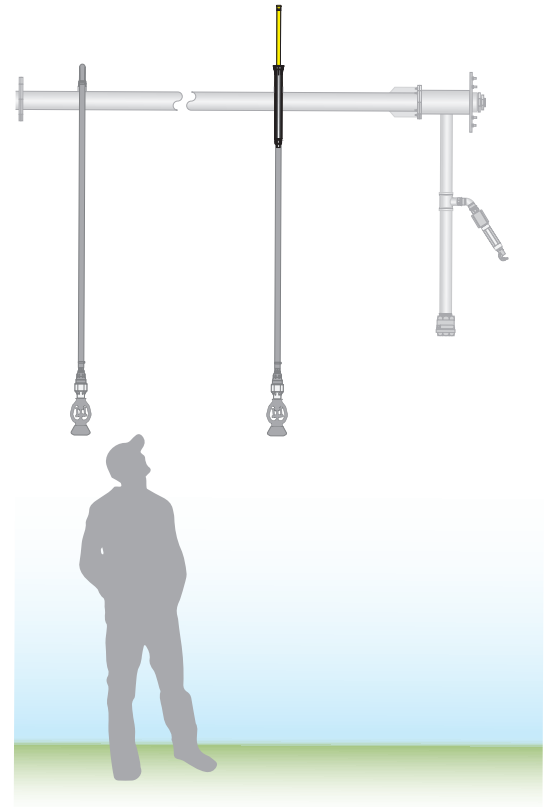

Website senninger.com | **Customer Support** +1-407-877-5655

The Senninger commitment to world-class products, local support and technical expertise ensure we provide the most efficient and reliable agricultural irrigation solutions available in the world today.

Steve Abernethy, President of Senninger Irrigation